

REV.	ECN NUMBER	DESCRIPTION	DATE	DRAWN	CHECKED	APPROVED
A	ECN202324	FIRST EDITION	11/19'20	hu	Martin	ken

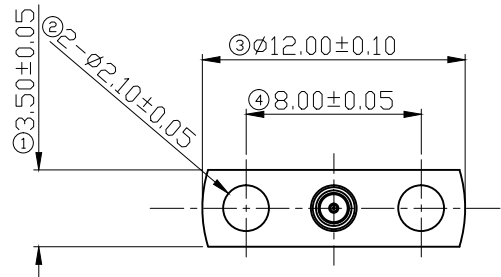

预压前离座子距离  
DISTANCE FROM SEAT  
BEFORE PRELOADING

最大偏摆  
MAX DEFLECTION

夹具下压力最大8N  
THE MAXIMUM PRESSURE  
UNDER THE FIXTURE IS 8N

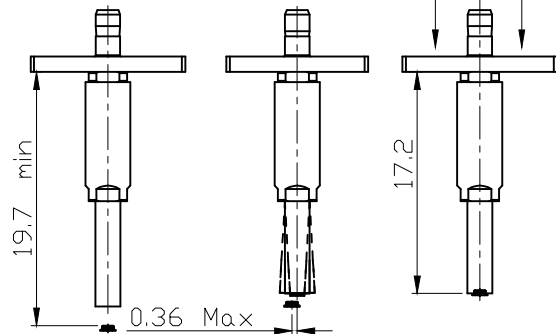

技术参数 TECHNICAL PARAMETERS:

- 电气特性 ELECTRICAL CHARACTERISTICS  
特性阻抗 CHARACTERISTIC IMPEDANCE: 50 Ω  
频率范围 FREQUENCY RANGE: DC-8GHZ  
电压驻波比 VSWR: <1.2@DC-3GHZ; <1.3@3-6GHZ; <1.4@6-8GHZ  
插入损耗 INSERTION LOSS: <0.4DB@DC-3GHZ; <0.6DB@3-6GHZ; <0.8DB@6-8GHZ  
介质耐压 DIELECTRIC WITHSTAND VOLTAGE: > 300 V AC/1MIN
- 机械特性 MECHANICAL CHARACTERISTICS  
外导体弹力 ELASTIC FORCE OF OUTER CONDUCTOR: 3.5±1N (弹簧压缩 SPRING COMPRESSION 1.0±0.1MM)  
中心针弹力 ELASTIC FORCE OF CENTER NEEDLE: 1.8±0.4N (弹簧压缩 SPRING COMPRESSION 0.7±0.1MM)  
连接器整体弹力 OVERALL ELASTICITY OF THE CONNECTOR: ≤8N  
针头初始偏摆量 INITIAL DEFLECTION OF NEEDLE: ≤0.1MM  
机械耐久性 MECHANICAL DURABILITY: > 10000次
- 环境特性 ENVIRONMENTAL CHARACTERISTICS  
工作温度范围 OPERATING TEMPERATURE RANGE: -40 °C ~ +85 °C  
湿度范围 HUMIDITY RANGE: 15%~85%。  
有害物质需符合 ECT 《QE-Q-19-001 环境有害物质管理基准》 管控标准。  
HARMFUL SUBSTANCES MEET ECT “《QE-Q-19-001 ENVIRONMENTAL HARMFUL SUBSTANCES MANAGEMENT STANDARDS》” CONTROL SPECIFICATION.
- 重点管控 KEY CONTROL:  
标有 “▼” 为重点检测尺寸, 标有 “[X]” 为要求做 CPK 检测尺寸, 标有 “⊗” 为首样全检尺寸;  
MARKED “▼” FOR QIP ITEMS, AND MARKED “[X]” FOR CPK ITEMS, MARKED “⊗” FOR FAI ITEMS;

成品激光刻字内容:  
ECT WYYY001  
ECT代表深圳电连,  
WYYY代表年周,  
例如: 2019年第15  
周, 刻1915  
FINISHED LASER  
ENGRAVING CONTENT:  
ECT WYYY001  
ECT STANDS FOR  
SHENZHEN ELECTRIC  
CO., LTD., WYYY  
STANDS FOR YEAR  
AND WEEK,  
FOR EXAMPLE: THE  
15TH WEEK OF 2019,  
ENGRAVED 1915

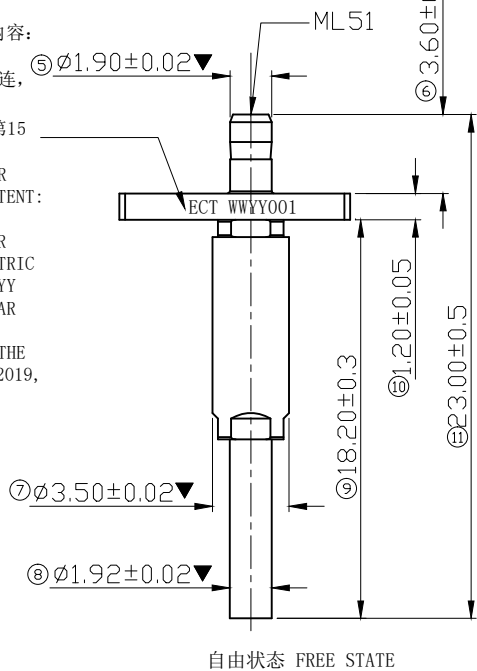

自由状态 FREE STATE

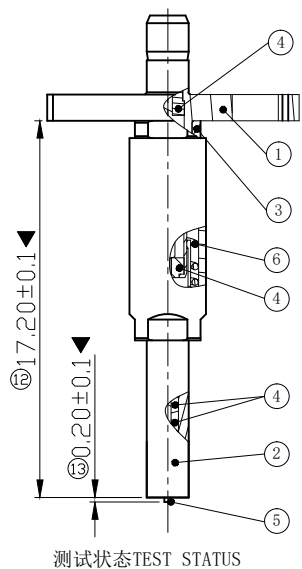

测试状态 TEST STATUS

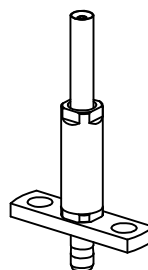

参考3D视图 REFERENCE 3D VIEW

6	弹簧 SPRING	不锈钢&钝化 STAINLESS STEEL & PASSIVATION
5	探针 PROBE	镀铜&镀金 BECU&GOLD PLATED
4	绝缘子 INSULATOR	PTFE
3	外壳 SHELL	黄铜&镀镍 BRASS & NICKEL PLATED
2	外导体 OUTER CONDUCTOR	黄铜&镀金 BRASS & GOLD PLATED
1	法兰 FLANGE	黄铜&镀金 BRASS & GOLD PLATED
NO.	DESCRIPTION	FINISH



GENERAL TOLERANCE	
XX.± 0.25	XX.°± 2°
X.± 0.20	X.°± 1°
.X± 0.10	.X°± 0.5°
.XX± 0.03	

SCALE:	1:1
UNIT:	mm
SIZE:	A4

DRAWN:	Hu
CHECK:	
APPROVE:	

DATE:	11/19'20
DATE:	
DATE:	

DWG.NO:	600-23359-01
PARTS NO.(INTENDED USE):	818023359

TITLE:	USS RF TEST ADAPTER 6GEN 23*8*3.5
--------	--------------------------------------

REV.	A
SHEET:	1/1