

REV.	ECN NUMBER	DESCRIPTION	DX1TE	DRX1WN	CHECKED	X1PPROVEI
A	ECN202324	FIRST EDITION	03/29/22	Beam	Martin	ken

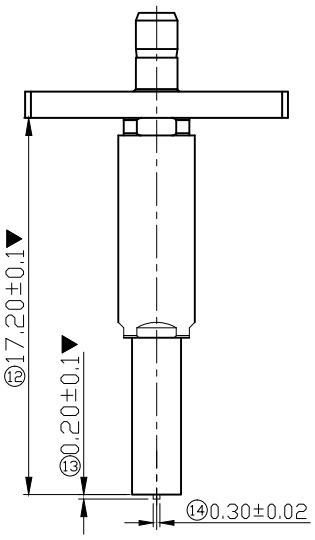
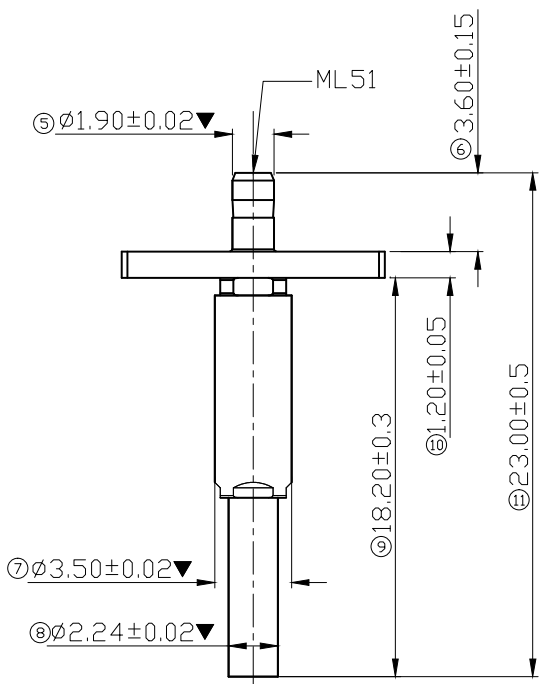
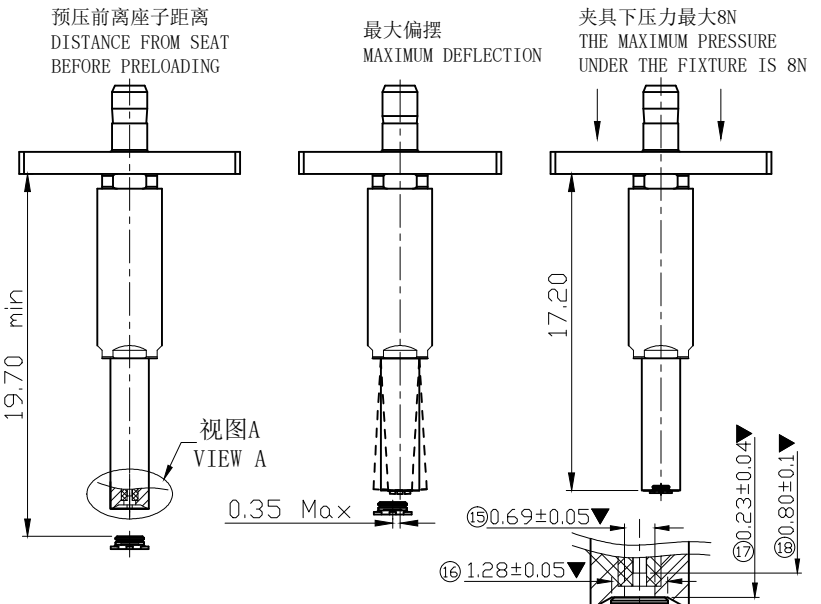
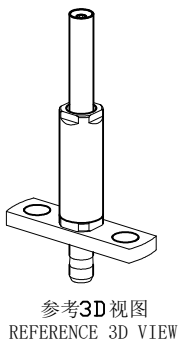
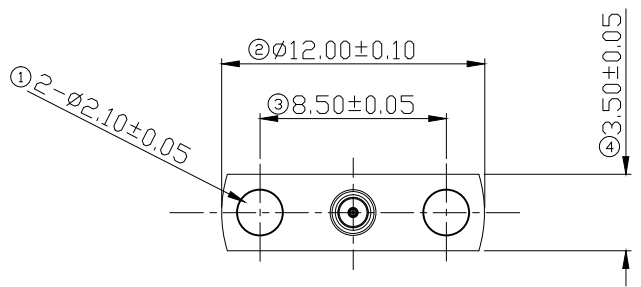

技术参数 TECHNICAL PARAMETERS:

1. 电气特性 ELECTRICAL CHARACTERISTICS  
 特性阻抗 CHARACTERISTIC IMPEDANCE: 50 Ω;  
 频率范围 FREQUENCY RANGE: DC-8 GHz;  
 电压驻波比 VSWR: <1.2@DC-3GHz; <1.3@3-6GHz; <1.4@6-8GHz;  
 插入损耗 INSERTION LOSS: <0.4dB@DC-3GHz; <0.6dB@3-6GHz; <0.8dB@6-8GHz;  
 介质耐压 DIELECTRIC WITHSTAND VOLTAGE: > 300 V AC/1min;

2. 机械特性 MECHANICAL CHARACTERISTICS  
 外导体弹力 ELASTIC FORCE OF OUTER CONDUCTOR: 3.5 ± 1N (弹簧压缩 SPRING COMPRESSION 1.0 ± 0.1mm, 弹力测试行程 ELASTIC TEST STROKE 1.0mm);  
 中心针弹力 ELASTIC FORCE OF CENTER NEEDLE: 1.8 ± 0.4N (弹簧压缩 SPRING COMPRESSION 0.7 ± 0.1mm, 弹力测试行程 ELASTIC TEST STROKE 0.7mm);  
 机械耐久性 MECHANICAL DURABILITY: > 10000 CYCLES;

3. 环境特性 ENVIRONMENTAL CHARACTERISTICS  
 工作温度范围 OPERATING TEMPERATURE RANGE: -40 °C ~ +85 °C;  
 湿度范围 HUMIDITY RANGE: 15% ~ 85%;  
 有害物质需符合 ECT 《QE-Q-19-001 环境有害物质管理基准》 管控标准。  
 HARMFUL SUBSTANCES MEET ECT "《QE-Q-19-001 ENVIRONMENTAL HARMFUL SUBSTANCES MANAGEMENT STANDARDS》" CONTROL SPECIFICATION.

ELECTRIC CONNECTOR TECHNOLOGY	GENERX1L TOLERXINCE	SCX1ILE:	DRX1WN:	DX1TE:	DWG.NO:	TITLE:	REV.
	XX.± 0.25	XX.°± 2°	1:1	Martin	09/27/20	600-29017-01	A
	X.± 0.20	X.°± 1°	UNIT:	CHECK:	DX1TE:	PX1RTS NO.(INTENDED USE)	SHEET:
	.X± 0.10	.X°± 0.5°	mm	X1PPROVE:	DX1TE:	818029017	1/1
.XX± 0.03		SIZE: X14				USS RF TEST ADAPTER 6GEN 23*8.5*3.5	